

FORGED BRASS BALL VALVE

SAFETY EXHAUST

Two Piece Body • Full Port • Blowout Proof Stem
 Chrome Plated Ball • PTFE Seats and Seals • Locking Lever Handle

CODE # 68S (AKTAFS) THREADED

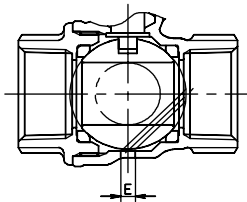
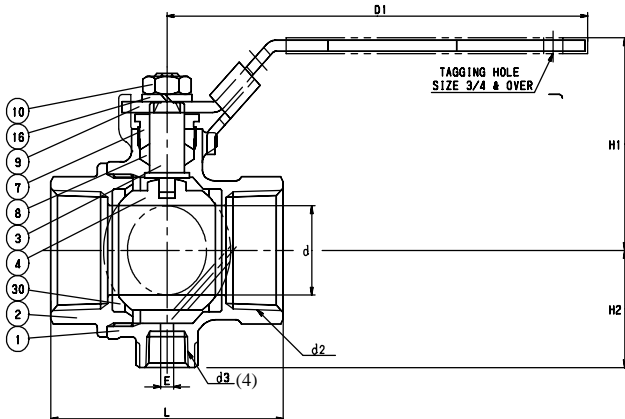

SIZE 1/4-3/4

STANDARDS	
END TO END	KITZ
END CONNECTION	ANSI B1.20.1
WALL THICKNESS	KITZ
CONFORMS TO MSS-SP 110	

PRESSURE/TEMPERATURE	
200 PSI NON-SHOCK COLD WATER, AIR & WATER	
NOTE:	PRESSURE/TEMPERATURE CHART - PAGE BV-29

MATERIAL LIST		
NO.	NAME OF PART	SPECIFICATION
1	BODY	FORGED BRASS (B283, C37700)
2	BODY CAP	FORGED BRASS (B283, C37700)
3	STEM	(1) SPECIAL BRASS (KITZ "K" METAL)
4	BALL	(2) FORGED BRASS (B283, C37700)
7	GLAND	BRASS ROD (B16)
8	GLAND PACKING	PTFE
9	HANDLE	(3) CARBON STEEL
10	HANDLE NUT	CARBON STEEL
16	SPRING WASHER	CARBON STEEL
30	BALL SEATS	PTFE

NOTES: (1) PROPRIETARY DEZINCIFICATION RESISTANT MATERIAL.
 (2) CR. PLATING
 (3) ELECTROPLATED ZINC WITH PLASTIC COVERING
 (4) 1/4" EXHAUST PORT (1"-2") (d3)
 EXHAUST MUFFLER AVAILABLE - OSHA: 1910:147 COMPLIANT

DIMENSIONS - WEIGHTS - QUANTITIES								
d2 SIZE	d	H1	H2	D1	L	E	APPROX. NET WT.	CARTON QTY
1/4	.31	1.54	-	3.23	1.61	.16	48	120
3/8	.31	1.54	-	3.23	1.65	.16	49	120
1/2	.51	1.65	-	3.23	2.09	.16	52	96
3/4	.71	2.01	-	3.94	2.36	.16	50	60
1	.91	2.32	1.28	5.12	2.83	.16	51	36
1 1/4	1.26	2.52	1.50	5.12	3.23	.16	50	24
1 1/2	1.57	2.87	1.73	5.91	3.62	.16	54	16
2	1.97	3.15	2.05	5.91	4.13	.16	72	16

SPECIFICATION

Approved valve shall have two piece forged brass body with safety exhaust, blowout proof stem, PTFE seats/seals, chrome plated ball, and full port design. Valves shall be pressure rated to 200 WOG and conform to MSS-SP 110.

KITZ Code No. 68S (AKTAFS) Threaded Ends