

# BUTTERFLY VALVES - 250 PSI

\*NSF372 • Wafer Design • Ductile Iron Body • Extended Neck  
Bi-Directional • Molded seat • ISO Mounting Pad • Gear Operator  
**SIZE 10" - 12"**

STANDARDS: MSS SP-67 & API 609 Cat.A END CONNECTION: ANSI CL 125/150 FLANGES WALL THICKNESS: KITZ STD

## MATERIAL LIST

NO.	NAME OF PART	SPECIFICATION
1	BODY	DUCTILE IRON (A536)
3	STEM (1)	STAINLESS STEEL (A276 Type 410) or STAINLESS STEEL (AISI Type 329)
4	DISC	DUCTILE IRON (A536) + ENP or ALUMINUM BRONZE or STAINLESS STEEL (A351 CF8M)
16A	NAME PLATE	ALUMINUM
16B	NAME PLATE	ALUMINUM
35	END PLATE BOLT	CARBON STEEL
36	GLAND PLATE BOL	STAINLESS STEEL
45A	O RING	NBR or EPDM
45B	O RING	NBR or EPDM
60	KEY	CARBON STEEL 12"
67A/B/C	STEM BEARING	METAL BACKED PTFE
99	SET BOLT	CARBON STEEL
102	GEAR UNIT	
103	BOTTOM STEM	STAINLESS STEEL (A276 Type 410) or STAINLESS STEEL (AISI Type 329)
106	SEAT RUBBER (2)	NBR or EPDM
144	GLAND PLATE	CARBON STEEL
145A/B	SPRING WASHER	CARBON STEEL
147	END PLATE	CARBON STEEL

(1) Line mark on top of stem indicates disc position.

(2) Vulcanized to the body



**Code # 5113 (B/E) G**

Stem: A276 type 410

Disc: Ductile Iron (A536 + ENP)

**Code # 5123 (B/E) G**

Stem: A276 type 410

Disc: ALUMINUM BRONZE \*

**Code # 5133 (B/E) G**

Stem: AISI Type 329

Disc: 316 SS (A351 CF8M) \*

**Code # 5153 (B/E) G**

Stem: A276 type 410

Disc: 316 SS (A351 CF8M) \*

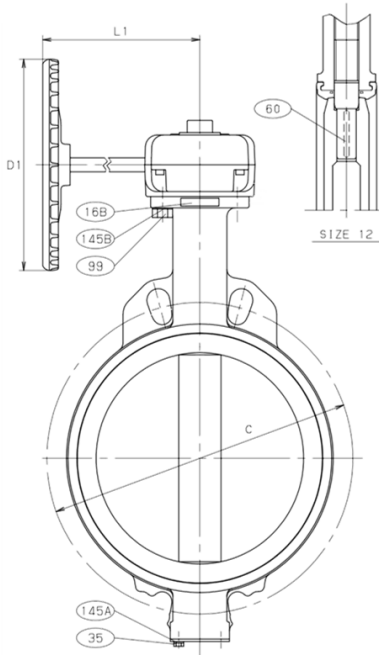
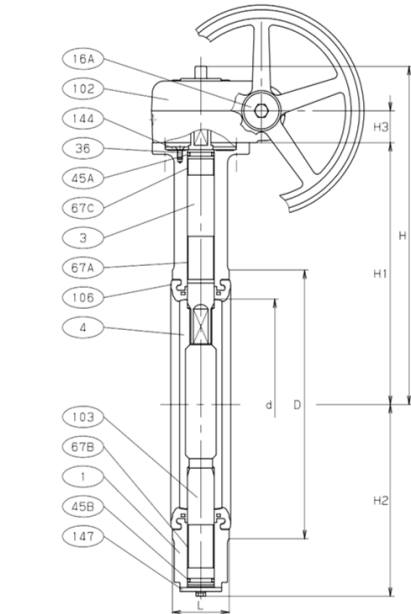

## DIMENSIONS • WEIGHTS

SIZE	d	H	H1	H2	H3	L	D	C	D1	L1	APPROX. WT.	
											Lbs	Kgs
in. 10	9.72	15.00	11.97	8.62	1.26	2.69	12.28	14.25	9.84	9.84	59	
mm 250	247	381	304	219	32	68	312	362	250	250	27	
in. 12	11.65	15.98	12.95	9.61	1.26	3.06	14.33	17.00	9.84	9.84	78	
mm 300	296	406	329	244	32	78	364	432	250	250	35	



\*Butterfly valves with AlBrz or SS disc conform with lead content requirements for "lead free" plumbing as defined by California, Vermont, Maryland, and Louisiana state laws and the U.S. Safe Drinking Water Act. These products further conform with the requirements of NSF/ANSI Standard 372.

**KITZ**

10750 CORPORATE DRIVE • STAFFORD, TEXAS

DJ SERIES BUTTERFLY VALVES - 250 PSI - GEAR OPERATOR